

# avenlur

## Walnut MOD Monkeybar 79in by Avenlur



### Need Help?

CALL US AT 888.697.3931 / M-F 9AM - 5PM PT (12PM - -8PM ET)

OR EMAIL US AT [INFO@AVENLUR.COM](mailto:INFO@AVENLUR.COM)

V2

## **WARNING**

Adult assembly required.

## **WARNING**

Maximum user weight: 220 lbs (100kg) per child.

## **WARNING**

### **CHOKING HAZARD:**

Adult assembly required. Keep small assembly parts out of reach of children.

 Use under adult supervision.

**OBSERVE ALL STATEMENTS AND WARNINGS TO REDUCE THE LIKELIHOOD OF SERIOUS OR FATAL INJURY. SAVE THIS SHEET FOR FUTURE REFERENCE.**

## **OPERATION INSTRUCTIONS**

1. An adult should always supervise use of this product by children of all ages.
2. Instruct children not to attach items to the playground equipment that are not specifically designed for use with the equipment (examples: ropes, clothesline, pet leashes, cables and chain, etc) as they may cause a strangulation hazard or any other hazard.
3. Never allow children to use the equipment in a manner other than intended.

## **MAINTENANCE INSTRUCTIONS**

1. Inspect the product periodically for loose or damaged components. **Tighten bolts if need.**
2. Check all connections and bolts for tightness at least twice monthly during the usage.
3. Check all coverings and bolts for sharp edges.

## **INSTALLATION INSTRUCTIONS**

Please have an electrical drill available for assembly if possible.

If you have difficulty in installation, please contact us for help and get installation video for reference.

### **Please Ensure:**

1. You are assembling with at least two people to ensure that all sides and parts are leveled.
2. You don't screw the parts in too hard or it will splinter the wood.
3. You follow the directions carefully.

### **CONTACT US BEFORE ASSEMBLY IF:**

- You need assistance with assembly
- You need a replacement part due to a missing part or defective part

Call us at 888-697-3931 M-F 9AM-5PM PT

or email us at [info@avenlur.com](mailto:info@avenlur.com)



① ×1 39.5in



② ×1 39.5in



③ ×1 39in



④ ×1 39.5in

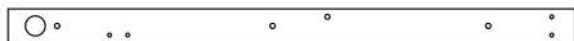

⑤ ×1 39.5in



⑥ ×1 39.5in



⑦ ×1 39in



⑧ ×1 39.5in



⑨ ×2 21.5in



⑩ ×5 21.5in



⑪ ×4 22in



⑫ ×16 20in



⑬ ×2 49in



⑭ ×2 49in



⑮ ×2 21.5in

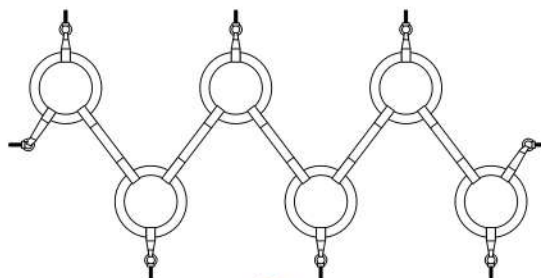

⑯ ×1



M7×50  
① ×68



M8×50  
② ×4



M8×20  
③ ×8

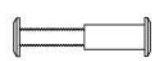

M6×20 M6×20  
④ ×8



M6×150  
⑤ ×6



M8×100  
⑥ ×4



M8  
⑦ ×8



M8  
⑧ ×8



M10×40  
⑨ ×8



M35  
⑩ ×8



13mm  
⑪ ×2

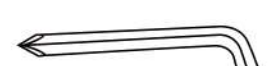

4mm  
⑫ ×2



M10×25  
⑬ ×2



5mm  
⑭ ×1



# 01-1

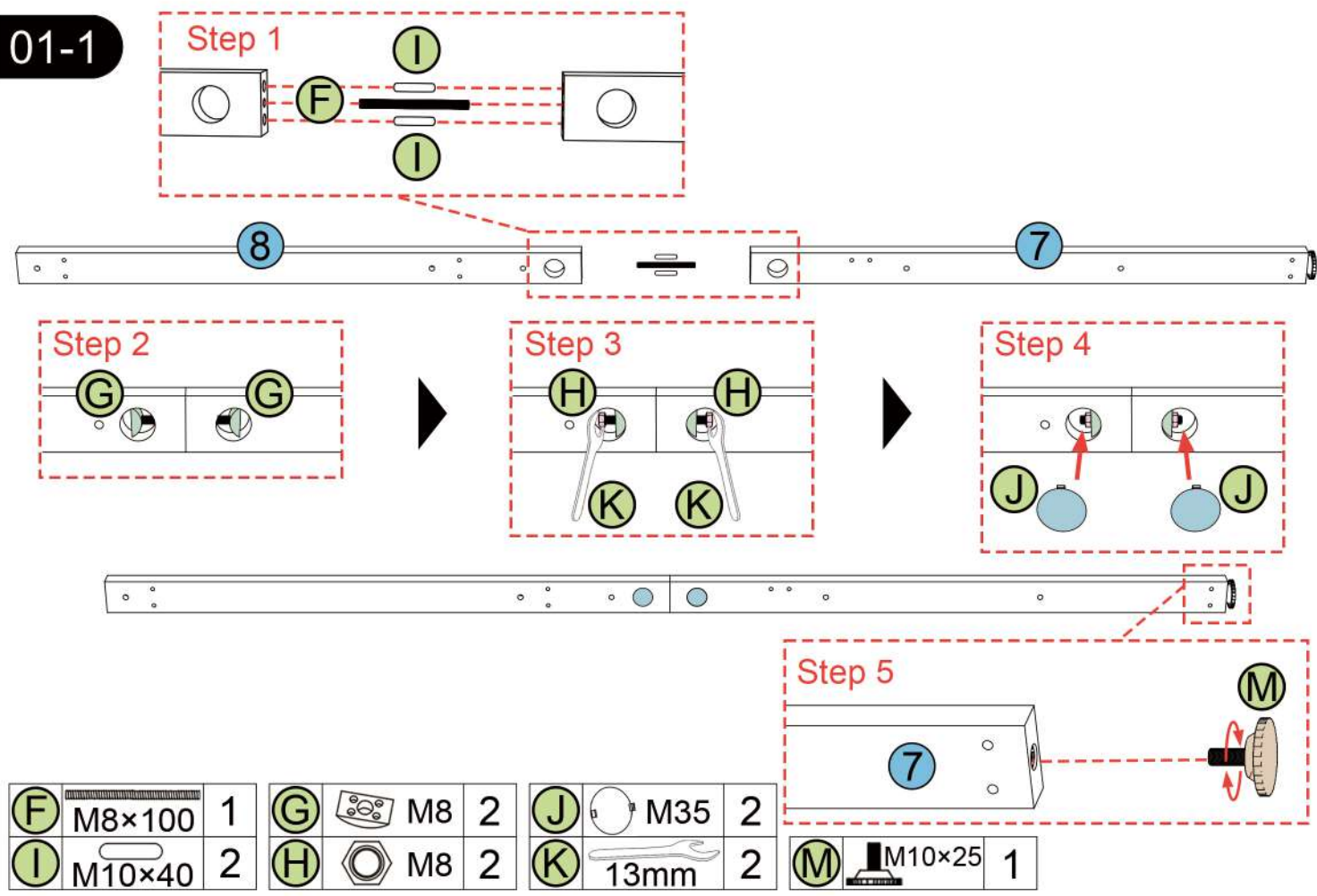

# 01-2

Note: Pay attention to all the black bubbled section markers. The manual may refer back to those later.

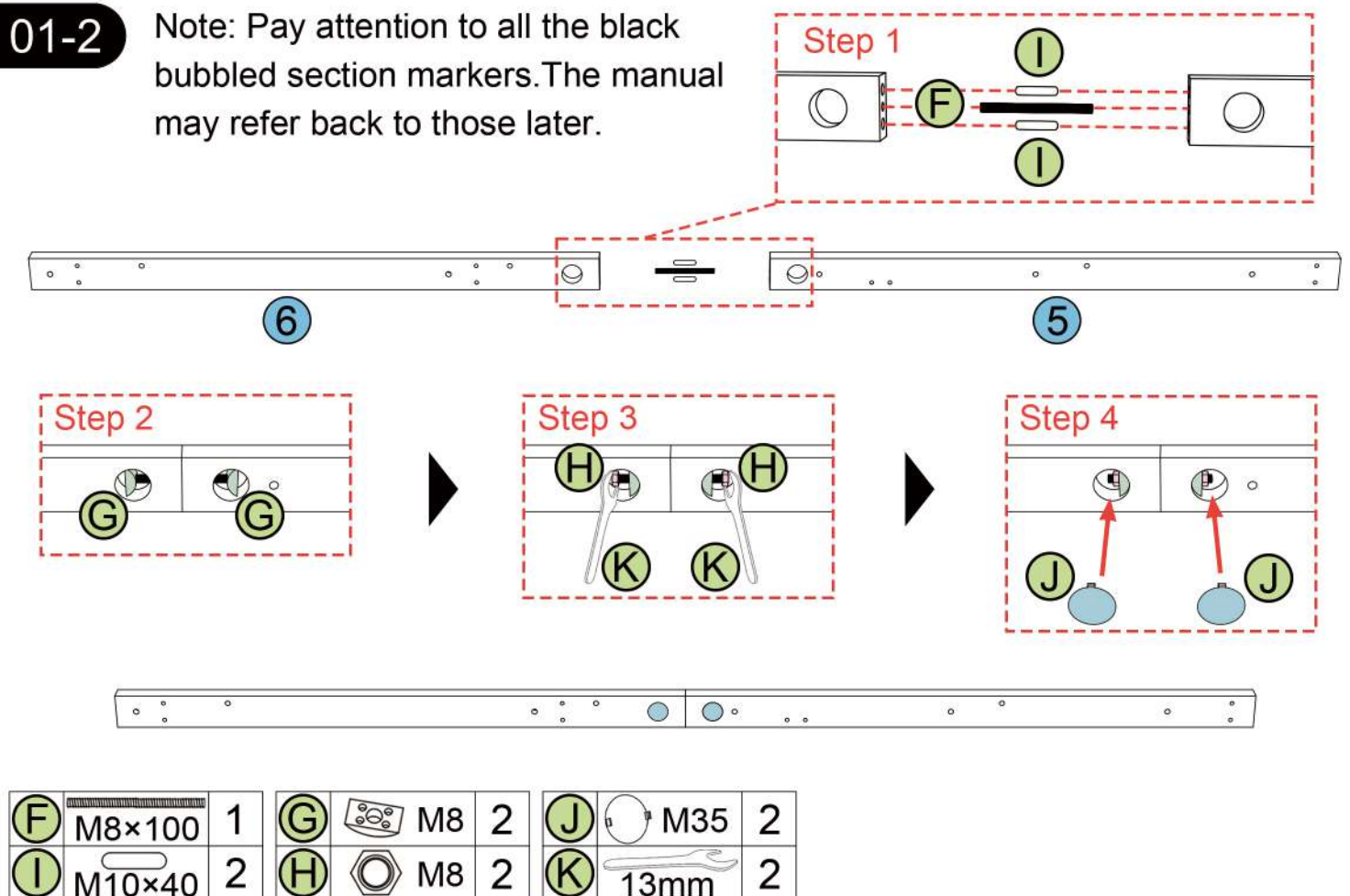

**01-3**

Note: The left ⑨'s countersink hole should be on the surface indicated by the arrow.

Note: The right ⑨'s countersink hole should be on the surface indicated by the arrow.

countersink

A x2

⑨

⑩

M7x50

16

# 01-4

Note: Do not tighten screws until after all screws are in place.

<b>(N)</b>	5mm	1
<b>(C)</b>	M8×20	8

02-1

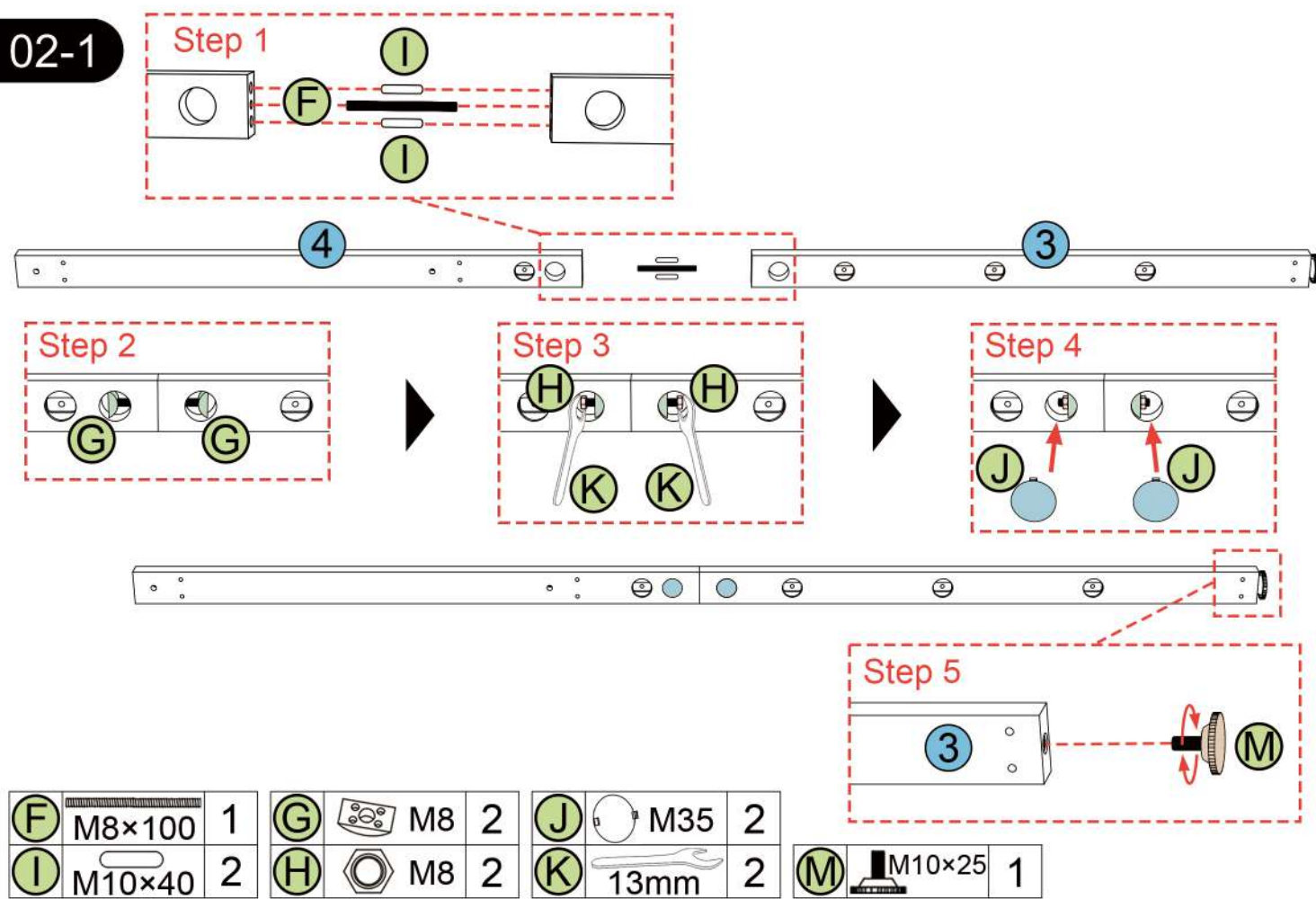

02-2

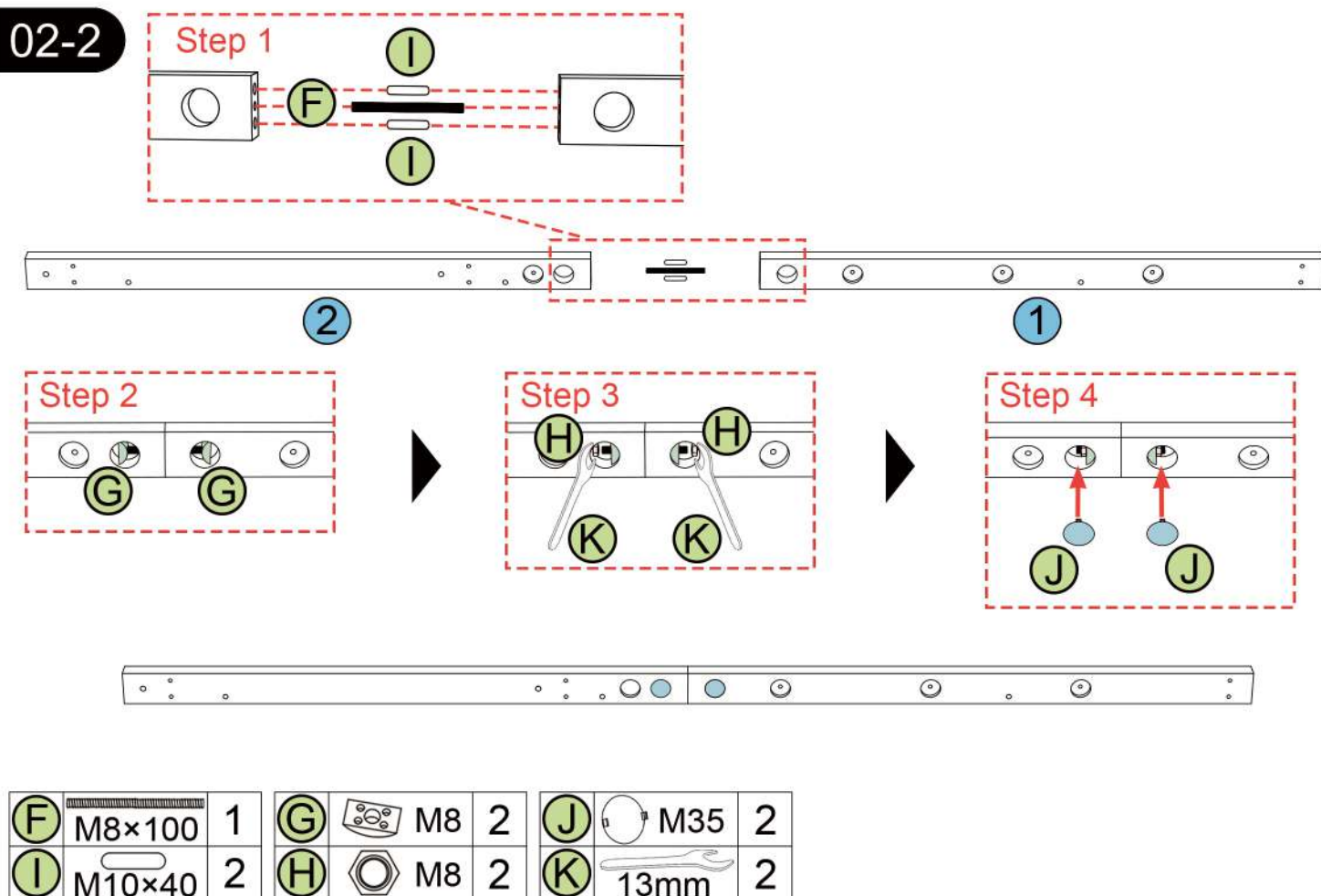



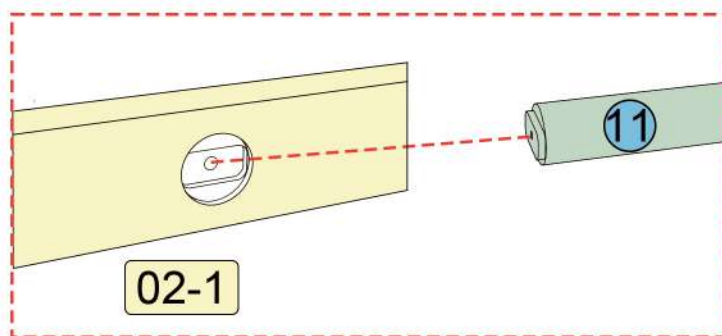
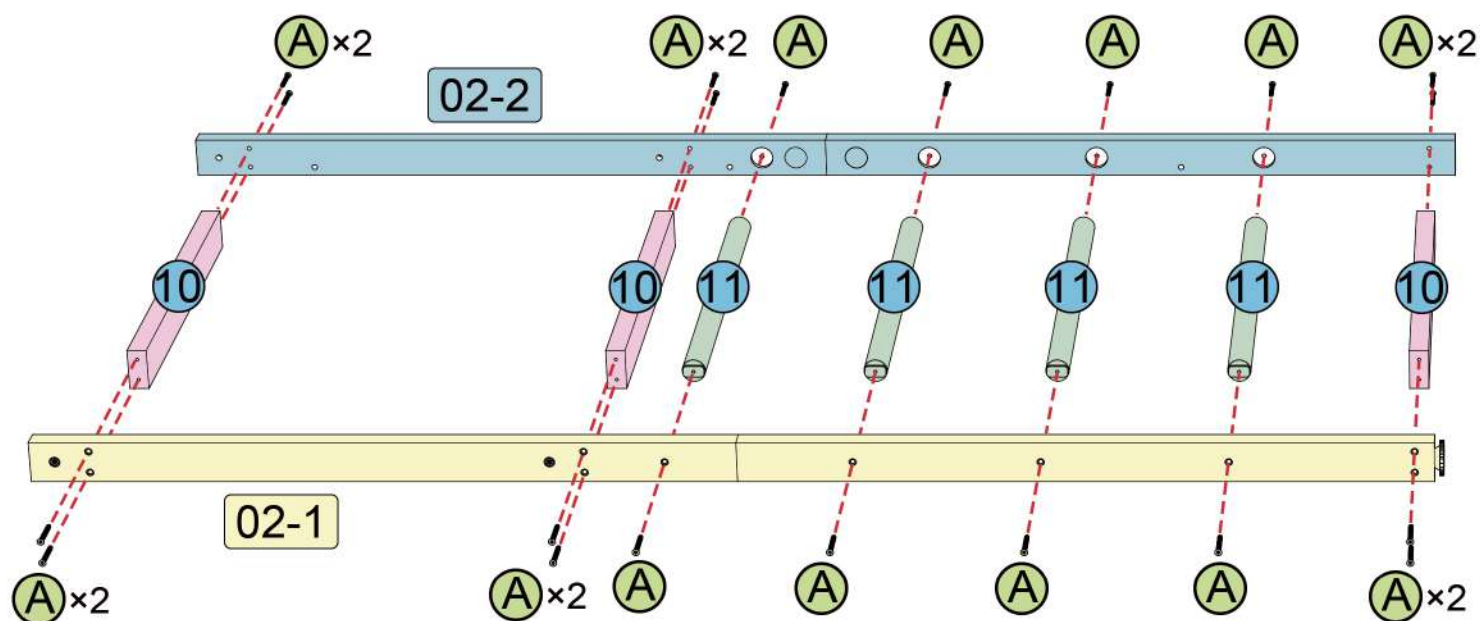

The protruding end of the part 11 needs to correspond to the hole of Section 02-1 when installed. Attach all screws for side 02-1 first and then attach side 02-2

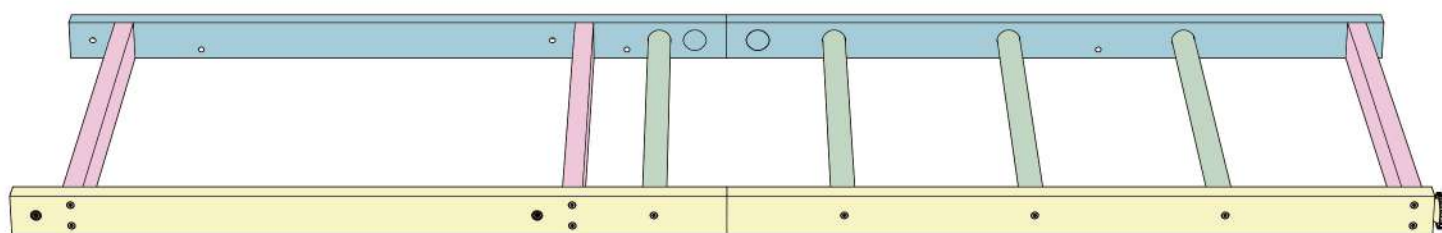

Use Wrench **L** to remove the 6 screws pointed by the red arrow.

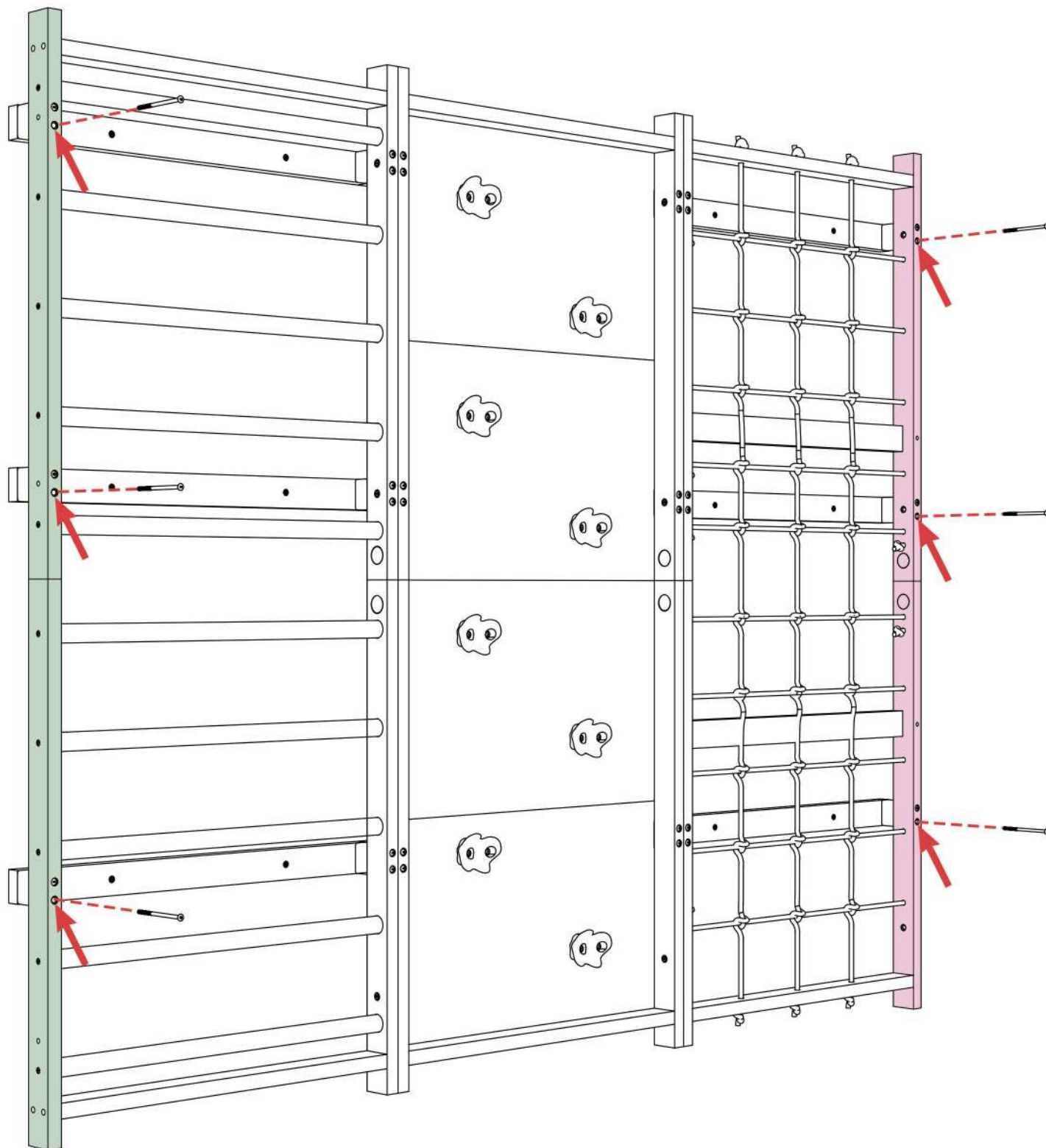



03-2

01-4

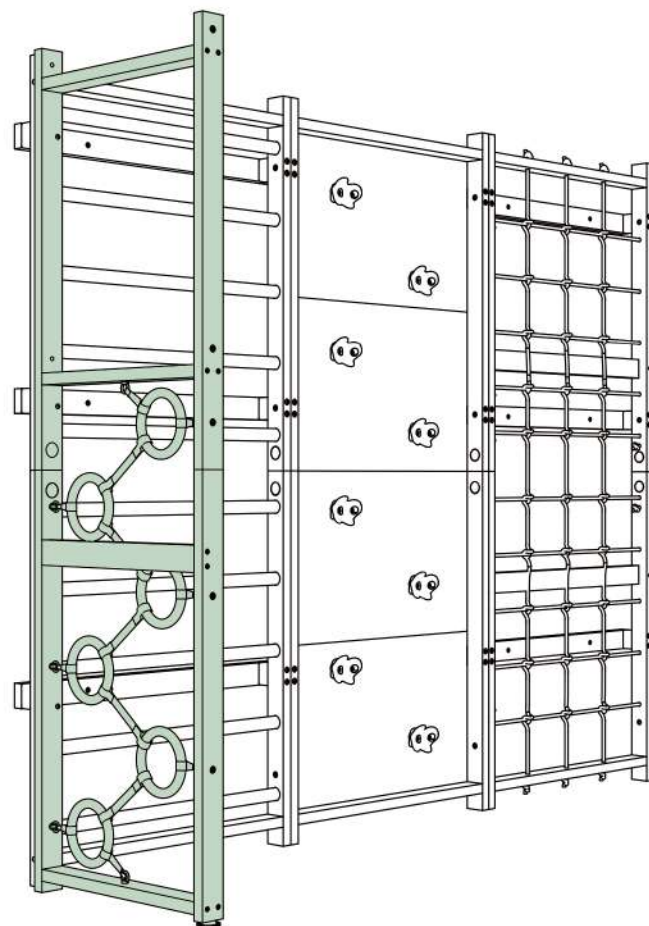
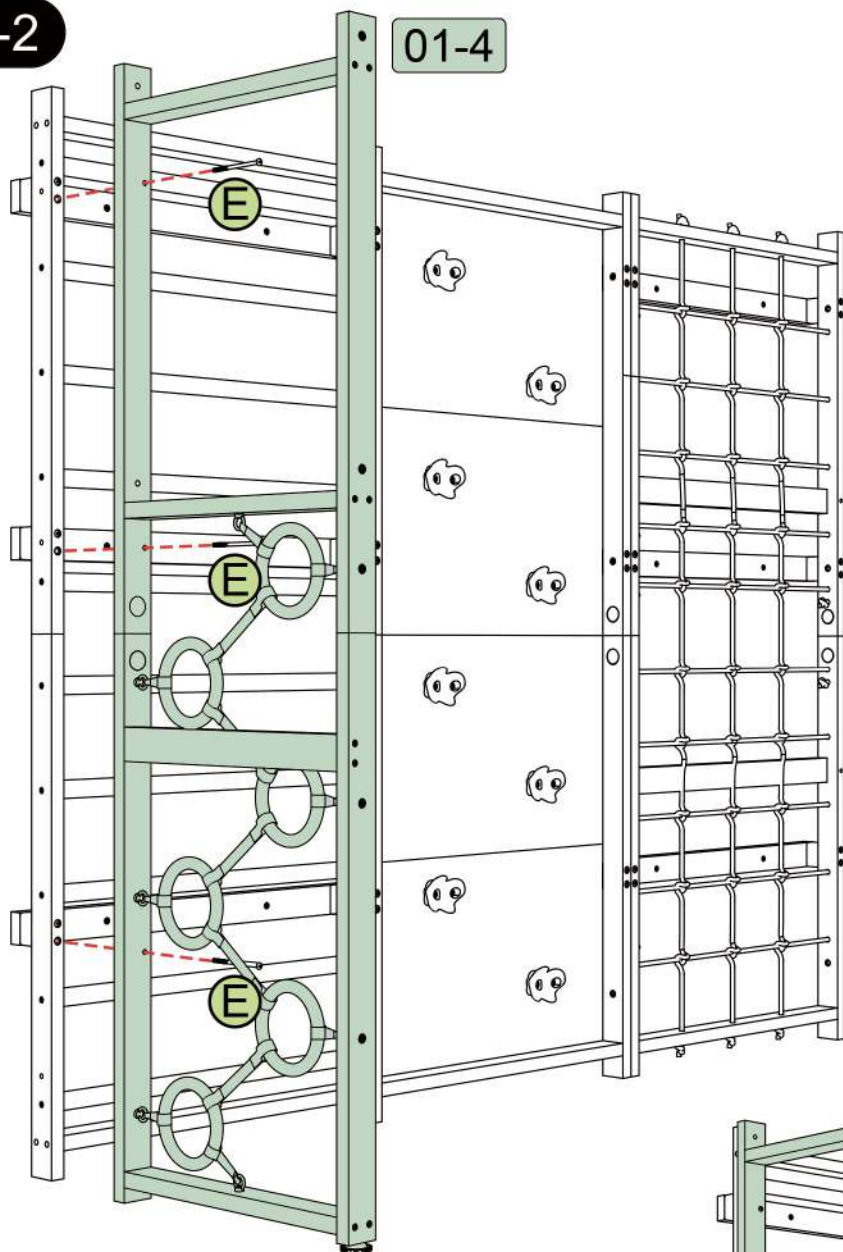

<b>E</b>	M6×150	3
<b>L</b>	4mm	1

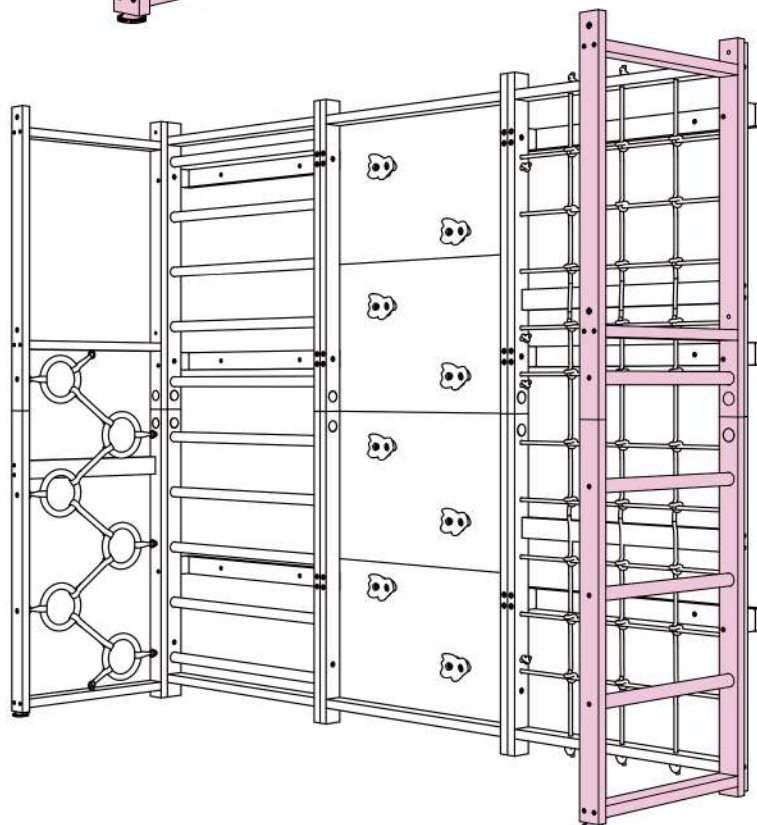
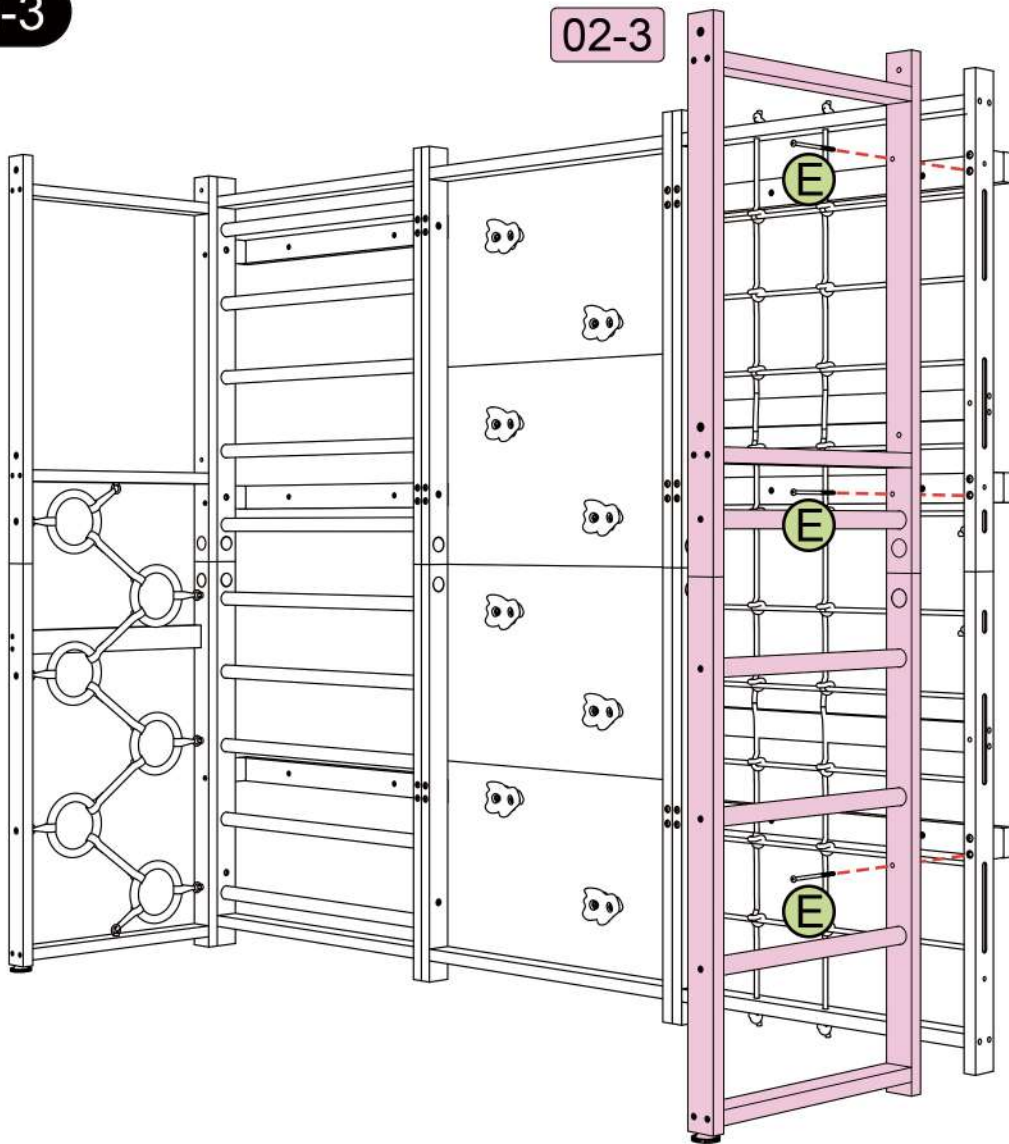

<b>E</b>	M6×150	3
<b>L</b>	4mm	1

## 04-1



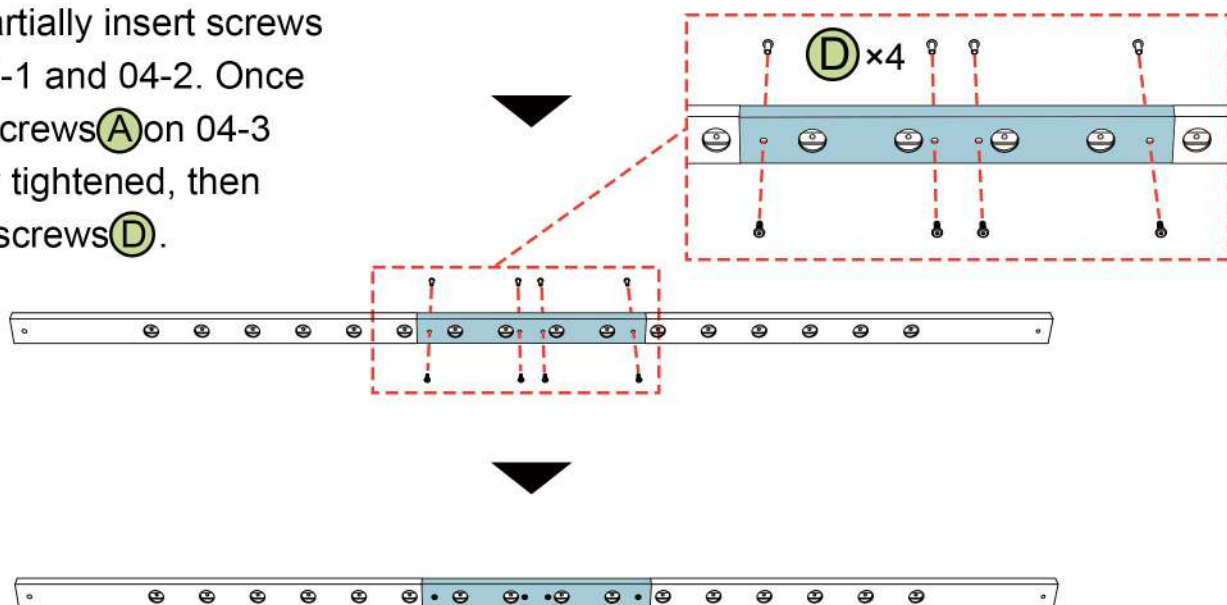

First, partially insert screws **D** on 04-1 and 04-2. Once all the screws **A** on 04-3 are fully tightened, then tighten screws **D**.

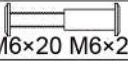
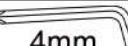

<b>D</b>	 M6×20 M6×20	4
<b>L</b>	 4mm	2

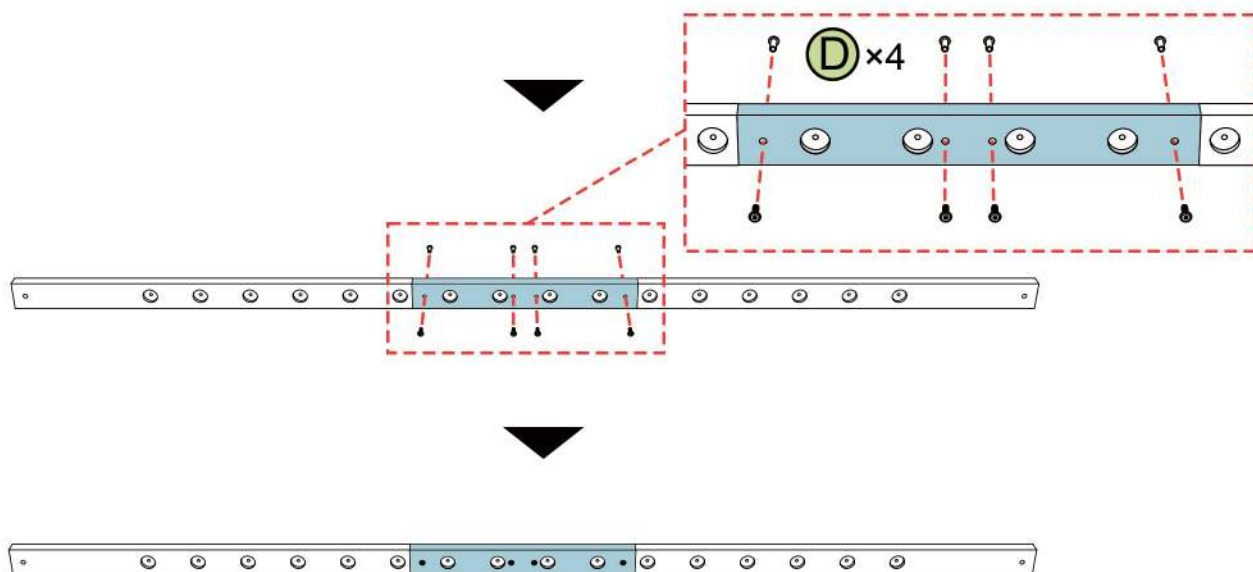
## 04-2



<b>D</b>	 M6×20 M6×20	4
<b>L</b>	 4mm	2



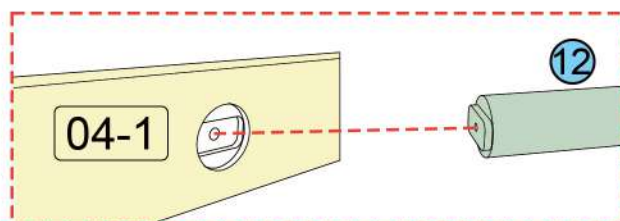
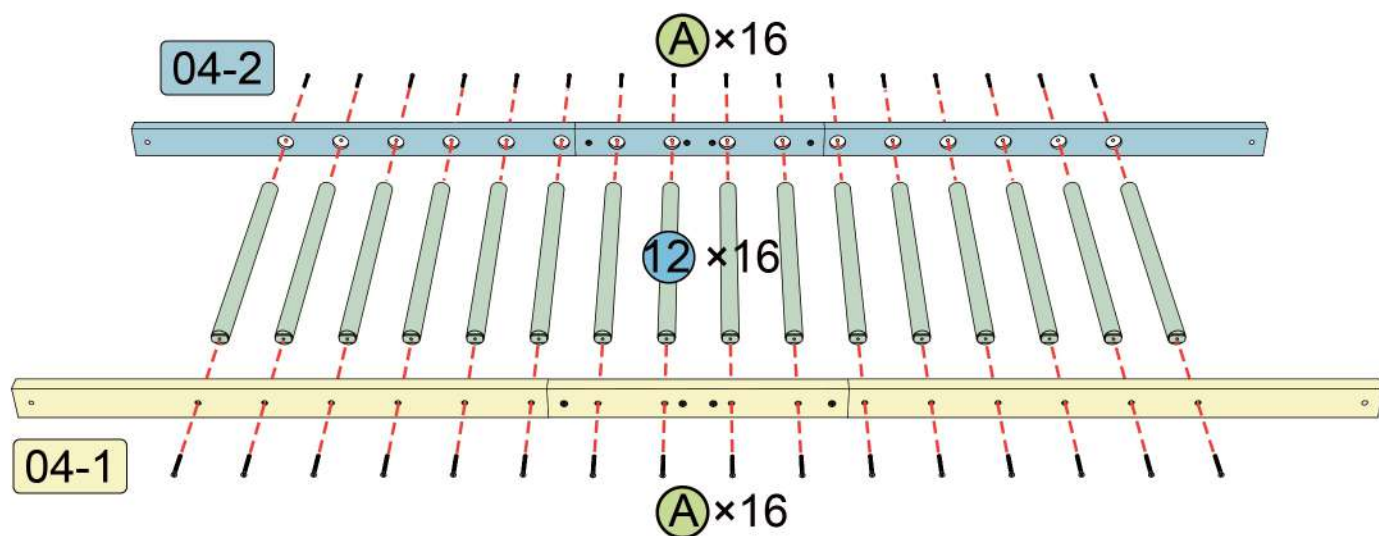

The protruding end of the part 12 needs to correspond to the hole of Section 04-1 when installed. Attach all screws for side 04-1 first and then attach side 04-2

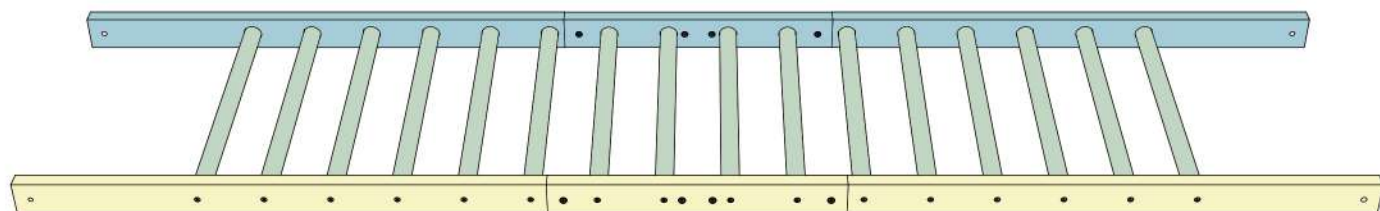

05-1

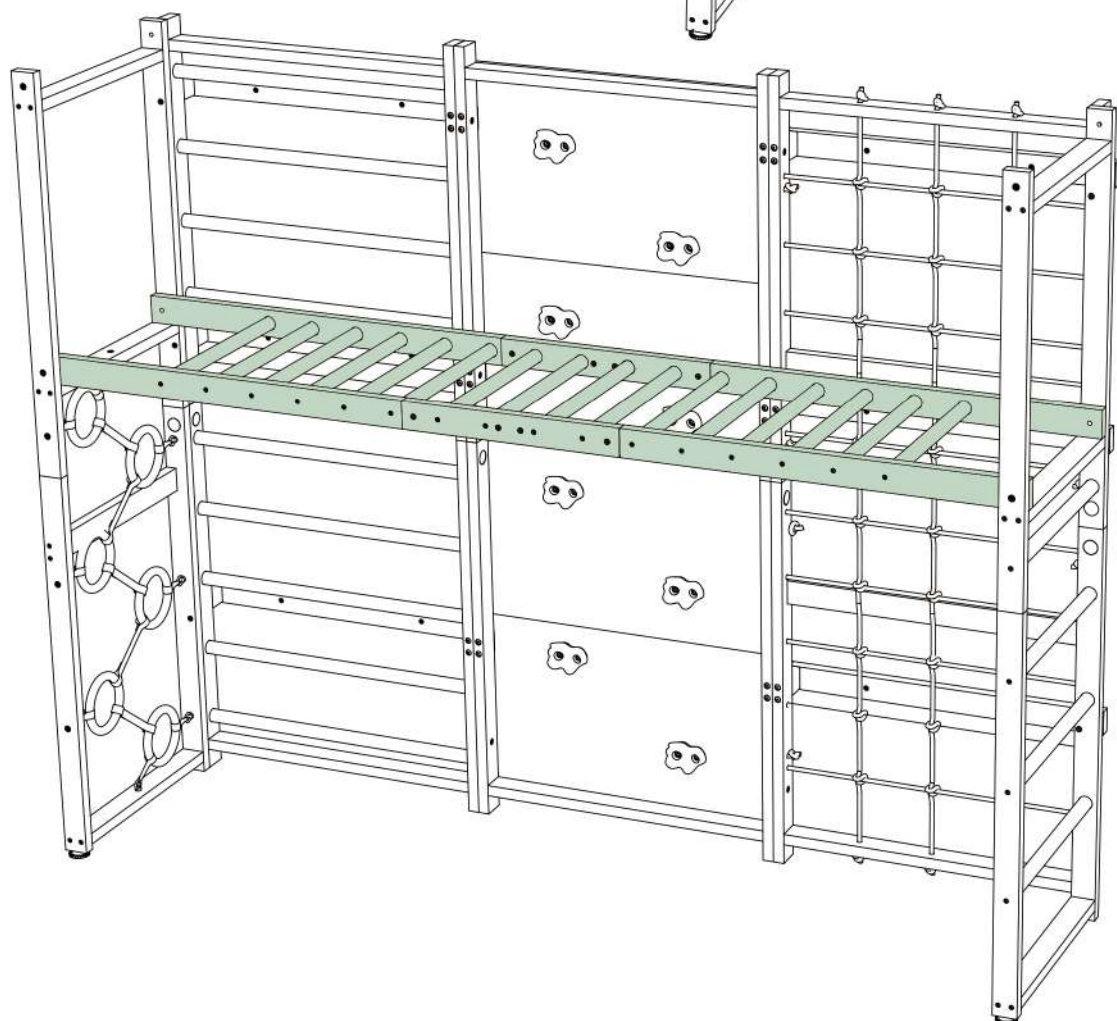
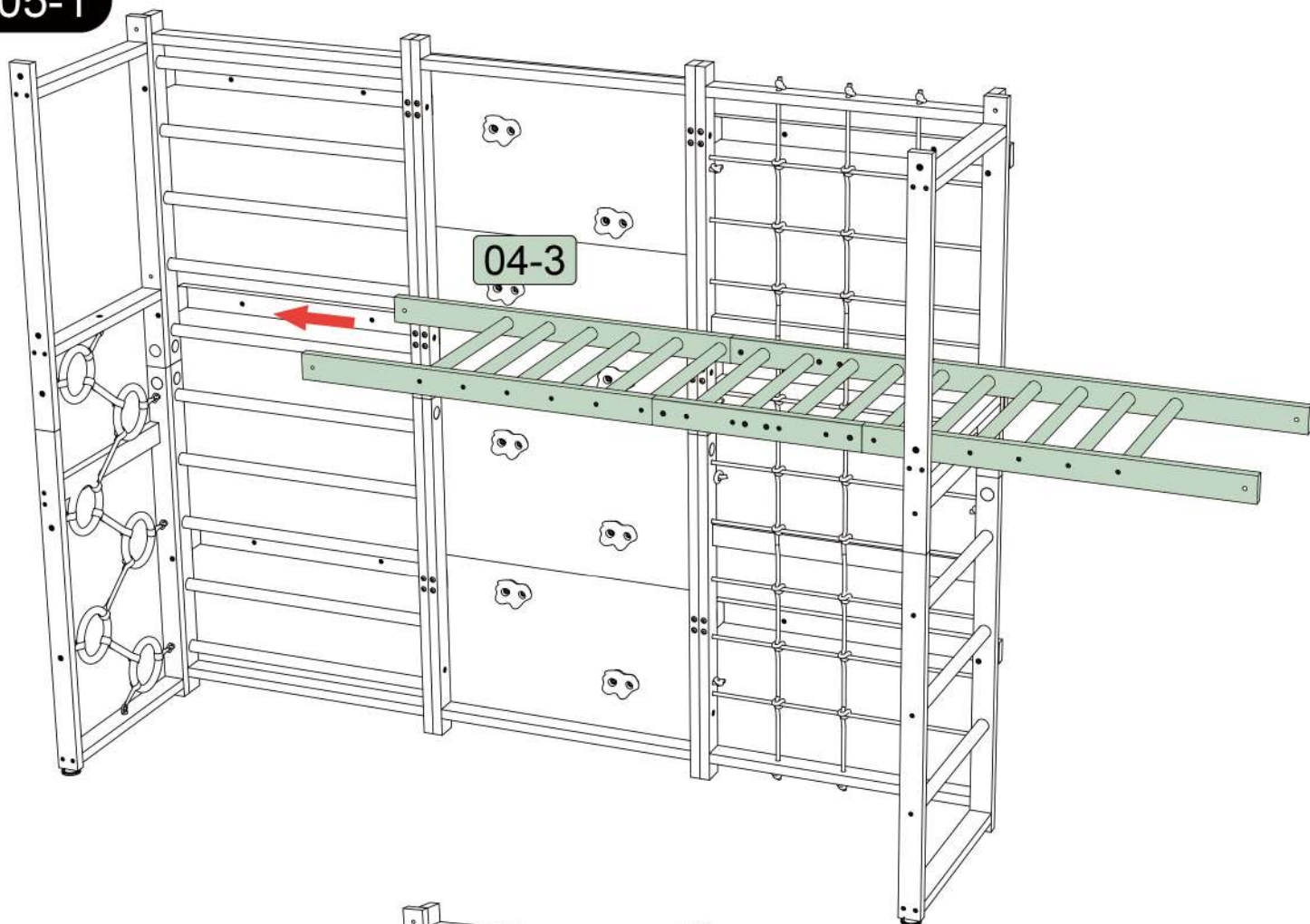



05-2

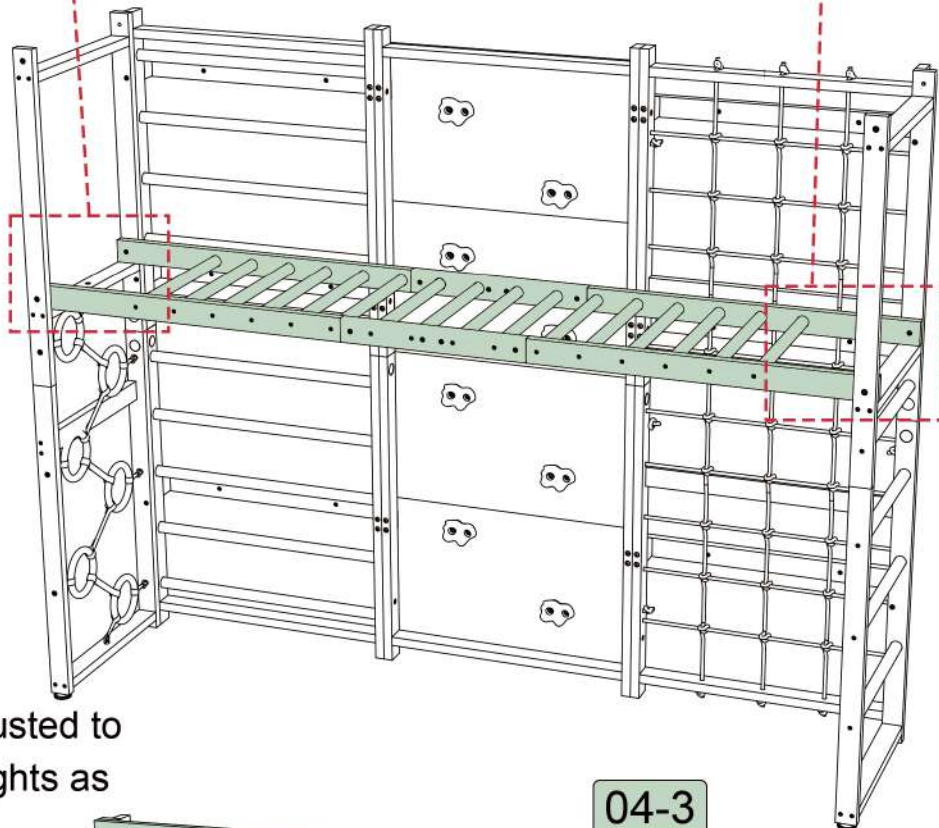
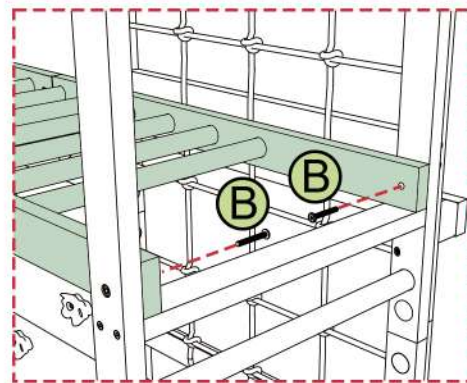
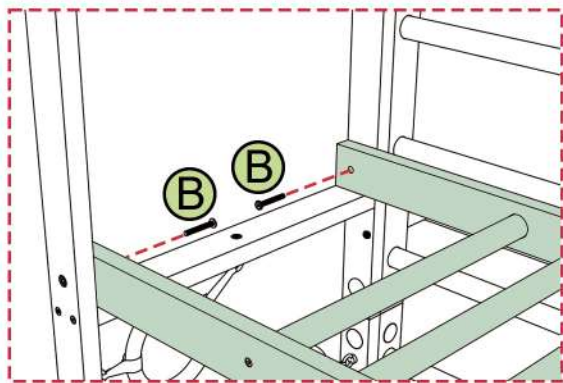

Monkey bars can be adjusted to two different desired heights as shown in the diagram.

04-3



(N)	5mm	1
(B)	M8×50	4



